

# FOREST PRESERVE DETAILED PROJECT WORK PLAN

## Fiscal Year 2025 Project # CO-WP-404

<u>Region</u> 5	<u>Project Title</u> Upper Chateaugay Lake Boat Launch Site (BLS) – Culvert Replacement
--------------------	---

<u>Project Type</u>	<u>Town(s)</u>	<u>County</u>	<u>Management Unit</u>
Modification of Existing Structure/Improvement	Ellenburg	Clinton	Chateaugay Lake BLS

### Description of Existing and Desired Condition(s) for Project

#### *Existing Conditions*

The existing site is operated as the only publicly accessible boat launching facility on Chateaugay Lakes. The site provides a concrete boat launch ramp and parking for 25 vehicle and trailers. The site is entered via a long paved access road entrance on the west side of State Route 374 in Merrill. The site access road has been temporarily repaired with stone and aggregate backfill after flood damage in 2023. The existing corrugated steel culvert under the facility access road was severely damaged and has reached the end of it’s service life since being installed in the mid-1960’s.

#### *Desired Conditions*

The desired condition is to maintain safe access to the boat launch facility for the public. This requires the replacement of a corrugated culvert pipe under the sole access road. The deteriorated culvert has reached the end of it’s serviceable life. This culvert failure requires DEC staff to repair the access road every year, sometimes multiple times a year, due to sinkholes and erosion. If the culvert is not replaced the facility will not be accessible for public use. Replacement of original 30-inch corrugated steel culvert with a 48-inch high density polyethylene (HDPE) culvert with heavy stone headwalls at inlet and a flared end at outlet is proposed. Repair and resurfacing with asphalt of the access roadway atop the culvert, which is necessary for egress to and from the boat launching site.

### Description of Project Specifications

Installation of replacement culvert and headwall will occur within the existing footprint of the roadway, shoulders and slopes, so the work area will be limited to the area immediately surrounding the culvert location, and the existing adjoining parking lot. A temporary repair to the roadway was constructed to address flood damage in 2023. This temporary repair facilitated egress however the temporary repair is no longer adequate. All material and equipment will be stored and stockpiled in the parking lot of



the boat launch, due to limited space on the access road, as well as environmental considerations. Excavation should be limited to the removal of the existing fill used to construct the temporary roadway. Estimated fill is approximately 110 cubic yards. The excavated fill is to be stockpiled on-site in the parking lot to be reused as base material for the new road. Additional earth disturbance will be necessary to seat culvert, stones, flared end, grade the road shoulders and embankments of and around the new culvert and roadway, but should be limited to the immediate area of the culvert.

Tree clearing will be limited to two trees over three-inches in diameter at breast height (DBH), there are no additional trees proposed for removal, please refer to the attached tree tally.

#### Description of Measures Taken to Avoid, Mitigate and Minimize Impacts to Natural Resources

The area of disturbance is expected to be limited to the immediate area of the invert, culvert and roadway repair. A series of silt fence and filter sock shall be installed downstream for sediment control and erosion control devices will be placed as necessary. Work will be performed only when the ditch is dry or under low flow conditions. Depending on the duration of the project and environmental conditions, filtration socks will be needed around the stockpiled fill material to prevent any overland sediment laden runoff from leaving the work area. Tree clearing has been minimized to only those trees that are necessary to excavate the existing culvert. The two trees that cannot be avoided are growing on top of the existing culvert along the road shoulder. No permanent encroachment into or impacts to streams, wetlands or waterbodies are anticipated as part of this project.

#### Analysis of Project Location and Design Alternatives

There are no reasonable alternatives for this project. This road entrance serves as the only entrance to the public boat launching facility on Upper Chateaugay Lake and this public access facility has no other road access available. The project is designed to sit within the footprint of the existing structures. As such, the surrounding existing conditions will experience little to no foreseeable change or impact from the installation of the replacement culvert and roadway repair.

#### Description of Use of Motorized Equipment and/or Motor Vehicles (if any)

To accomplish this work, it is anticipated that the following equipment will be utilized:

- Passenger cars/pick up trucks- For transportation of materials and laborers.
- Excavator - A 7/8 to one cubic yard hydraulic excavator for the necessary excavation and fill, to remove old culvert and lift new culvert into place.
- Dump trucks – Assuming one (1) for moving excavated material to and from on-site storage and one (1) for new asphalt.
- Equipment Trailer – Assuming one trailer making three (3) round trips for equipment and material delivery. Skid Steer, 72 inches wide with a 2,400 pound capacity for site restoration and cleaning of parking areas.
- Roller – for bed compaction and road paving.

#### Description of Applicable Standards for Accessibility by People with Disabilities

This project will have no impact (positive or negative) on ADA Accessibility. This project is to replace an entrance culvert and roadway.

Other Relevant Considerations

None

Prepared by (Name & Title): John Yuen (Environmental Engineer Tech 3) and James Pinheiro (Biologist I)

Date: 11/26/2025

Phone: (518) 897-1337

Approvals:

Comments:

Reviewed by Regional Forester Robert Daley on 3/12/2025.

*Robert Fiorentino*

---

Regional Program Manager  
Date: 4/23/2025

*Joseph M. Zolinski*

---

Regional Director  
Date: 1/21/2026

*Pete KA*

---

On Behalf of the Division Director  
Date: 1/5/2026



New York State Department of Environmental Conservation

REGULATORY CLEARANCE CHECKLIST – STATE LANDS and CONSERVATION EASEMENT PROJECTS					
PROGRAM	PERMIT	REQUIRED		SECURED BY	COMMENTS
		YES	NO	(NAME)	
Air Resources	Restricted Burning	<input type="checkbox"/>	<input checked="" type="checkbox"/>		
Mineral Resources	Mining	<input type="checkbox"/>	<input checked="" type="checkbox"/>		
Materials Management	Solid Waste Mgt. Fac.	<input type="checkbox"/>	<input checked="" type="checkbox"/>		
Water	Dam Safety Review	<input type="checkbox"/>	<input checked="" type="checkbox"/>		
	Const. in Flood Hazard	<input type="checkbox"/>	<input checked="" type="checkbox"/>		
	Public Water Supply	<input type="checkbox"/>	<input checked="" type="checkbox"/>		
	SPDES	<input type="checkbox"/>	<input checked="" type="checkbox"/>		
Spills Management	Petro. Bulk Storage	<input type="checkbox"/>	<input checked="" type="checkbox"/>		
Lands and Forests	Unit Management Plan	<input type="checkbox"/>	<input checked="" type="checkbox"/>		
	Tree Cutting	<input checked="" type="checkbox"/>	<input type="checkbox"/>	Jim Pinheiro	See attached tree tally
	Protected Native Plants	<input type="checkbox"/>	<input checked="" type="checkbox"/>		
	Historic Preservation	<input type="checkbox"/>	<input checked="" type="checkbox"/>		
Fish and Wildlife	Freshwater Wetlands	<input type="checkbox"/>	<input checked="" type="checkbox"/>		
	Wild Scenic & Rec. River	<input type="checkbox"/>	<input checked="" type="checkbox"/>		
Compliance Services	Other Protection of Waters	<input type="checkbox"/>	<input checked="" type="checkbox"/>		
	EAF	<input type="checkbox"/>	<input checked="" type="checkbox"/>		
	Negative Declaration	<input type="checkbox"/>	<input checked="" type="checkbox"/>		
	Env. Impact Statement	<input type="checkbox"/>	<input checked="" type="checkbox"/>		
	Water Quality Cert.	<input checked="" type="checkbox"/>	<input type="checkbox"/>	Jim Pinheiro	Blanket 401 WQC
DEC (other)	CP-17	<input type="checkbox"/>	<input checked="" type="checkbox"/>		
	Commissioner (aircraft, motorized equipment)	<input type="checkbox"/>	<input checked="" type="checkbox"/>		
	Flight Request	<input type="checkbox"/>	<input checked="" type="checkbox"/>		
	Contract Clearance Sh.	<input type="checkbox"/>	<input checked="" type="checkbox"/>		
	DOB Exemption	<input type="checkbox"/>	<input checked="" type="checkbox"/>		
Other Agencies	APA MOU	<input checked="" type="checkbox"/>	<input type="checkbox"/>	Jim Pinheiro	SL2024-0021
	APA Wetlands Permit	<input checked="" type="checkbox"/>	<input type="checkbox"/>	Jim Pinheiro	APA GP2005-1R
	Corps. of Engineers	<input checked="" type="checkbox"/>	<input type="checkbox"/>	Jim Pinheiro	NWP# 3
	Building Permits	<input type="checkbox"/>	<input checked="" type="checkbox"/>		
	Local Permits	<input type="checkbox"/>	<input checked="" type="checkbox"/>		
	Easements	<input type="checkbox"/>	<input checked="" type="checkbox"/>		
	Highway Enter DOT	<input type="checkbox"/>	<input checked="" type="checkbox"/>		
	Wastewater Disposal	<input type="checkbox"/>	<input checked="" type="checkbox"/>		





# UPPER CHATEAUGAY LAKE BLS CULVERT REPLACEMENT

TOWN OF DANMEMORA \* COUNTY OF CLINTON \* STATE OF NEW YORK

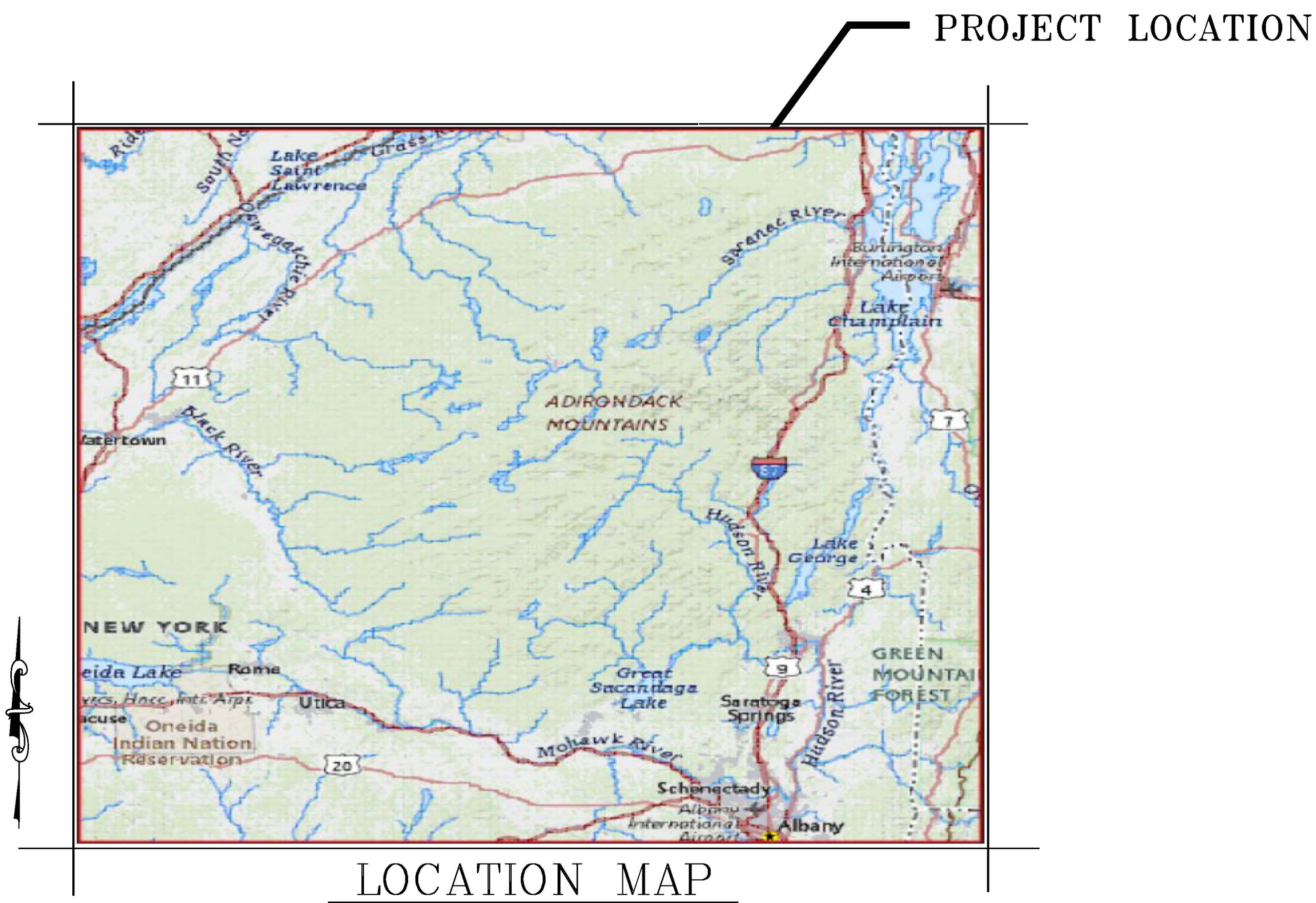

## INDEX

- T1 TITLE SHEET
- 1 EXISTING SITE PLAN
- 2 PROJECT PLANS & DETAILS

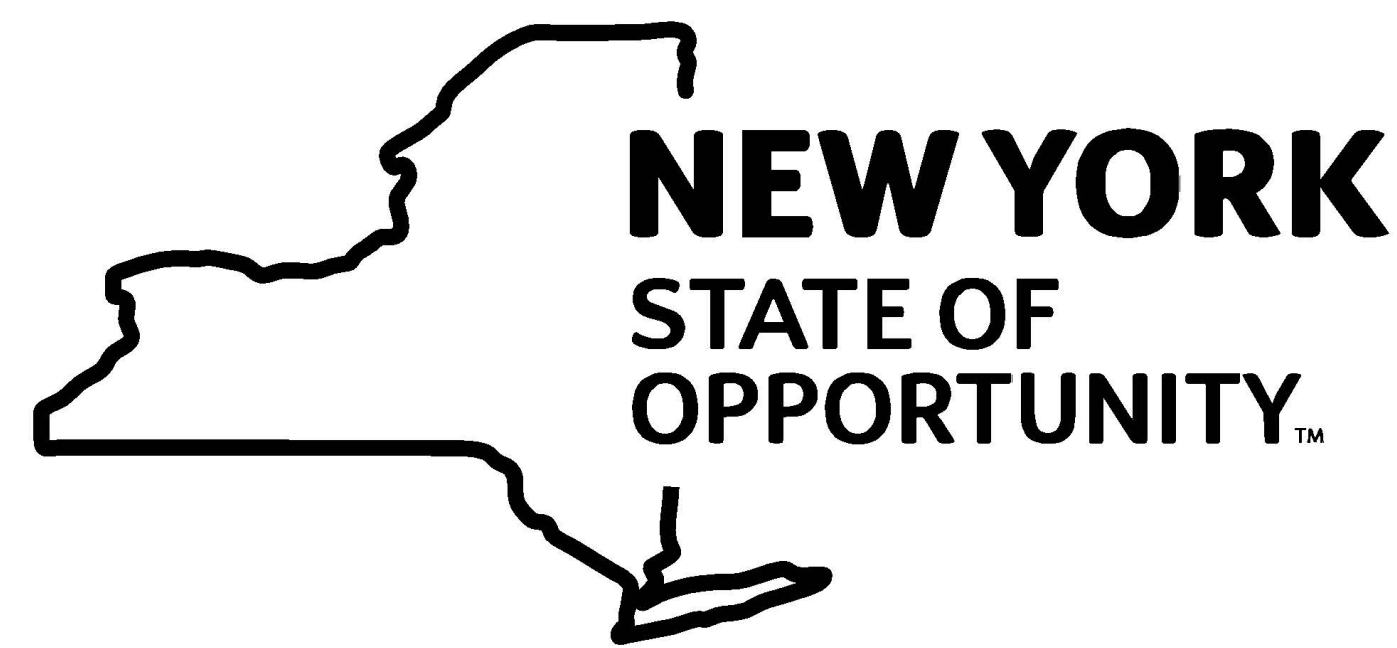

**Department of  
Environmental  
Conservation**

**Department of  
Environmental  
Conservation**



DIVISION OF OPERATIONS  
BUREAU OF MAINTENANCE AND TECHNICAL SERVICES

RECOMMENDED FOR APPROVAL BY:

DATE PROJECT ENGINEER BUREAU OF DESIGN AND CONSTRUCTION

DATE CHIEF BUREAU OF DESIGN AND CONSTRUCTION

DATE DIRECTOR DIVISION OF OPERATIONS

PROJECT DESCRIPTION  
UPPER CHATEAUGAY LAKE BLS  
CULVERT REPLACEMENT

TITLE SHEET

FACILITY NAME	UPPER CHATEAUGAY LK BLS
FACILITY NO.	1046
PROJECT NO.	5-2407
DATE	JAN. 2025
SCALE	AS NOTED
DRAWING NO.	T1

Chateaugay Narrows  
 Flow →  
 O.H.W.M. 1310.0  
 O.L.W.M. 1308.0

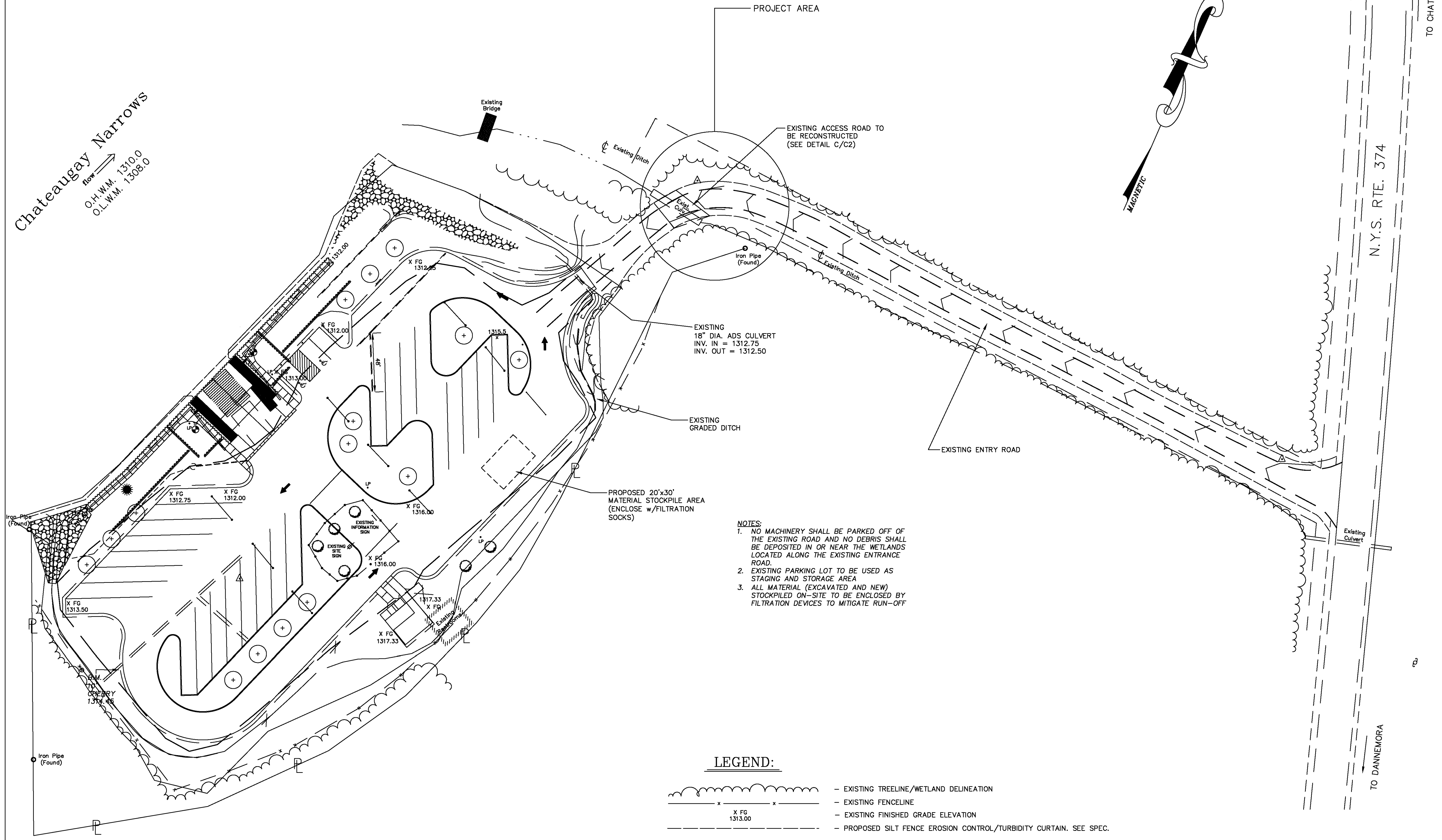

- NOTES:**
1. NO MACHINERY SHALL BE PARKED OFF OF THE EXISTING ROAD AND NO DEBRIS SHALL BE DEPOSITED IN OR NEAR THE WETLANDS LOCATED ALONG THE EXISTING ENTRANCE ROAD.
  2. EXISTING PARKING LOT TO BE USED AS STAGING AND STORAGE AREA
  3. ALL MATERIAL (EXCAVATED AND NEW) STOCKPILED ON-SITE TO BE ENCLOSED BY FILTRATION DEVICES TO MITIGATE RUN-OFF

**LEGEND:**

	- EXISTING TREELINE/WETLAND DELINEATION
	- EXISTING FENCELINE
	- EXISTING FINISHED GRADE ELEVATION
	- PROPOSED SILT FENCE EROSION CONTROL/TURBIDITY CURTAIN. SEE SPEC.

<b>Department of Environmental Conservation</b>		<b>NEW YORK STATE</b>		DIVISION OF OPERATIONS BUREAU OF MAINTENANCE AND TECHNICAL SERVICES	
RECOMMENDED FOR APPROVAL BY:					
DATE	PROJECT ENGINEER	DATE	CHIEF	DATE	DIRECTOR
	BUREAU OF DESIGN AND CONSTRUCTION		BUREAU OF DESIGN AND CONSTRUCTION		DIVISION OF OPERATIONS
PROJECT DESCRIPTION					
UPPER CHATEAUGAY LAKE BLS CULVERT REPLACEMENT					
EXISTING SITE PLAN					
FACILITY NAME					
UPPER CHATEAUGAY LK BLS					
FACILITY NO. 1046					
PROJECT NO. 5-2407					
DATE JAN. 2025					
SCALE 1" = 30'					
DRAWING NO. 1					

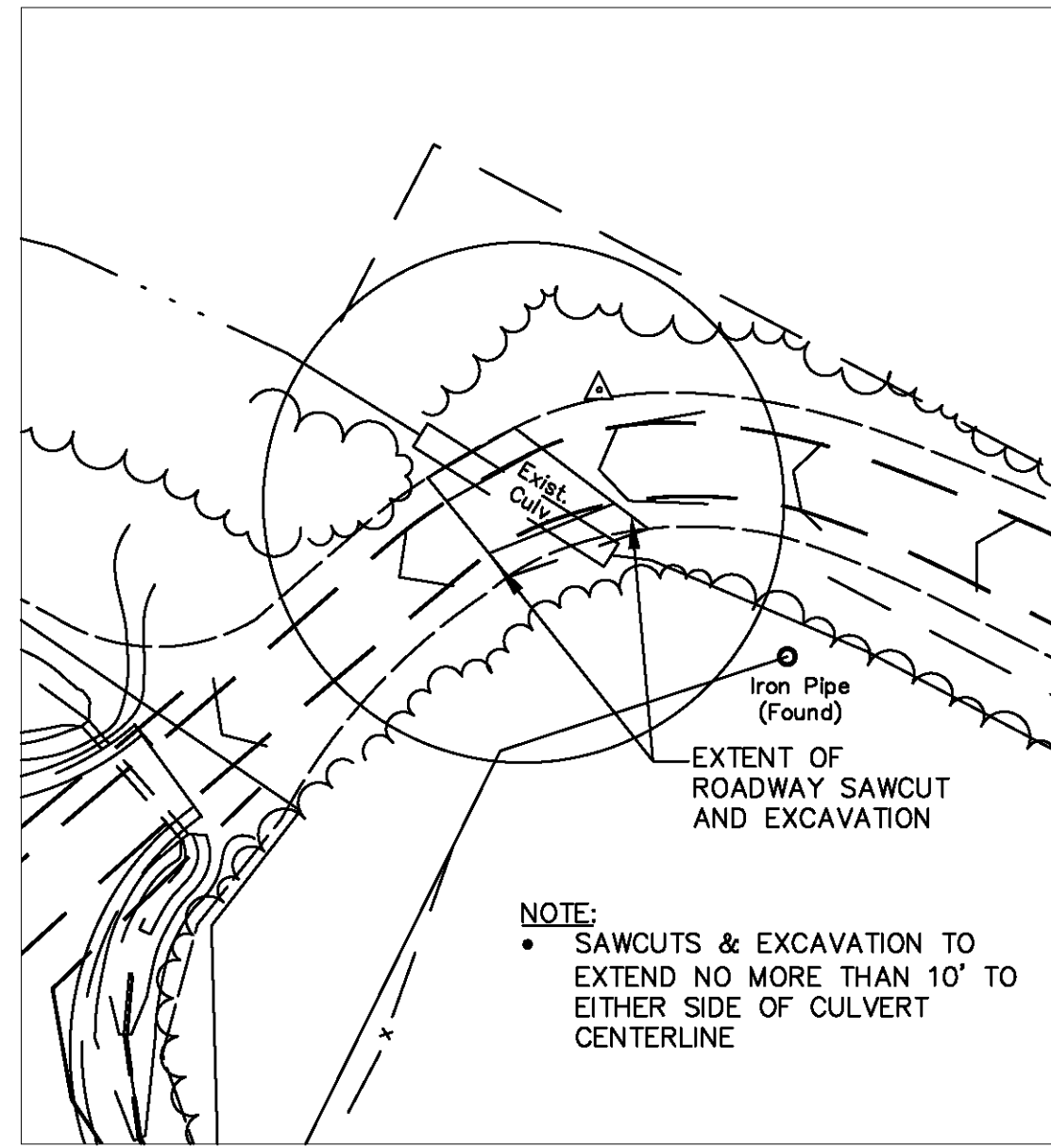

PROJECT AREA **A**  
SCALE: 1"=30'  
**2**

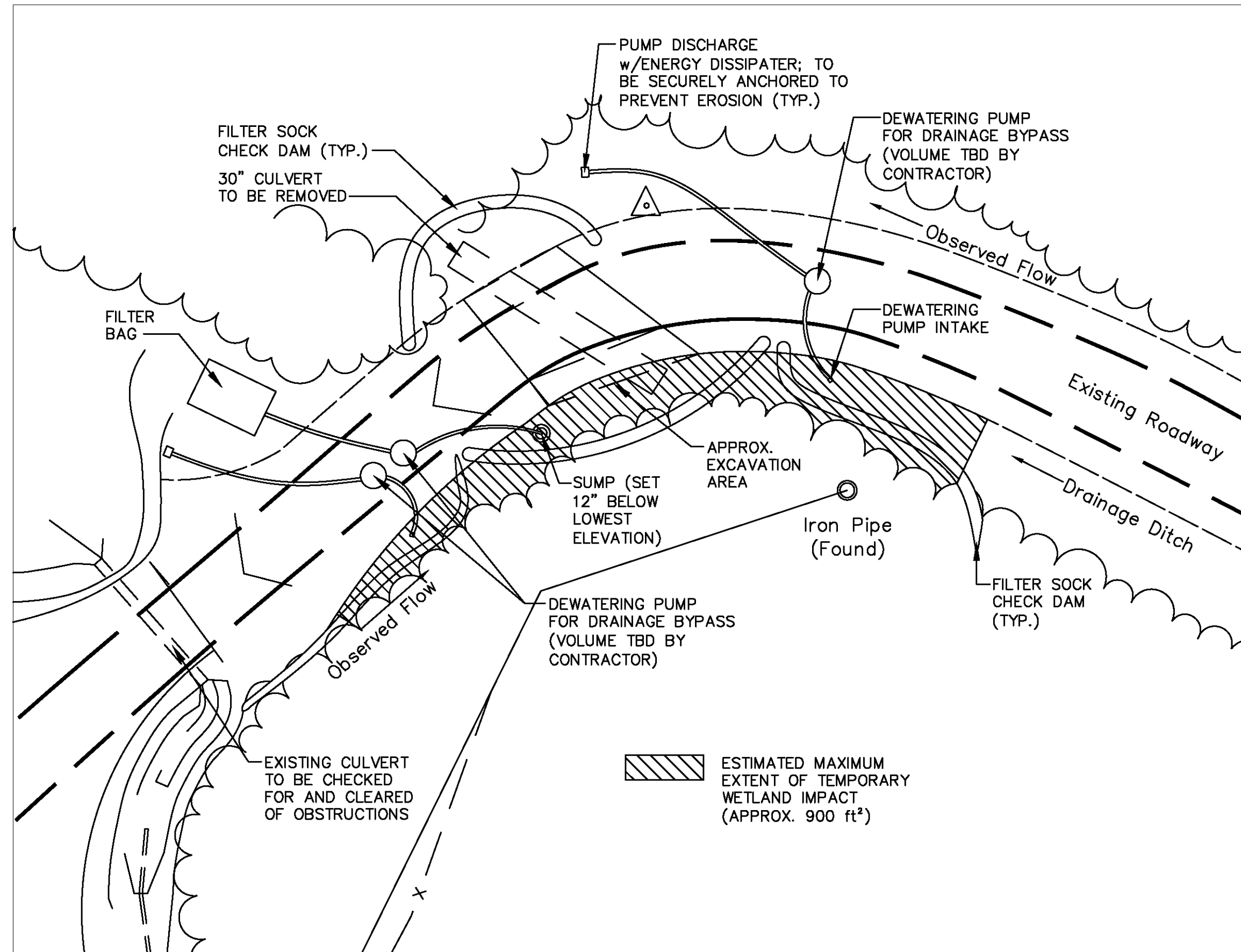

DEWATERING PROTECTION DETAIL **B**  
SCALE: 3/4"=1'-0"  
**2**

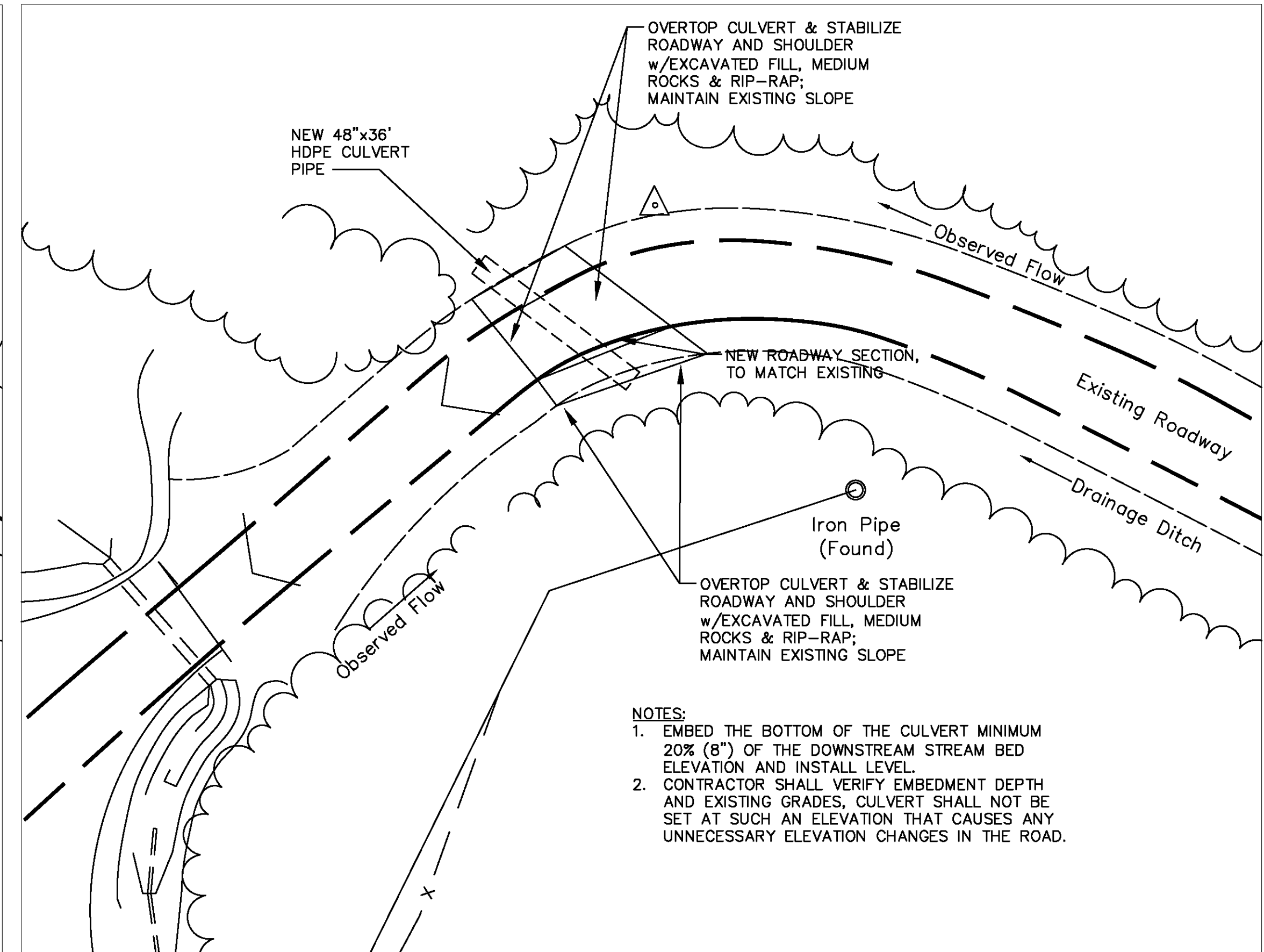

ROADWAY REBUILD DETAIL **C-1**  
SCALE: 3/4"=1'-0"  
**2**

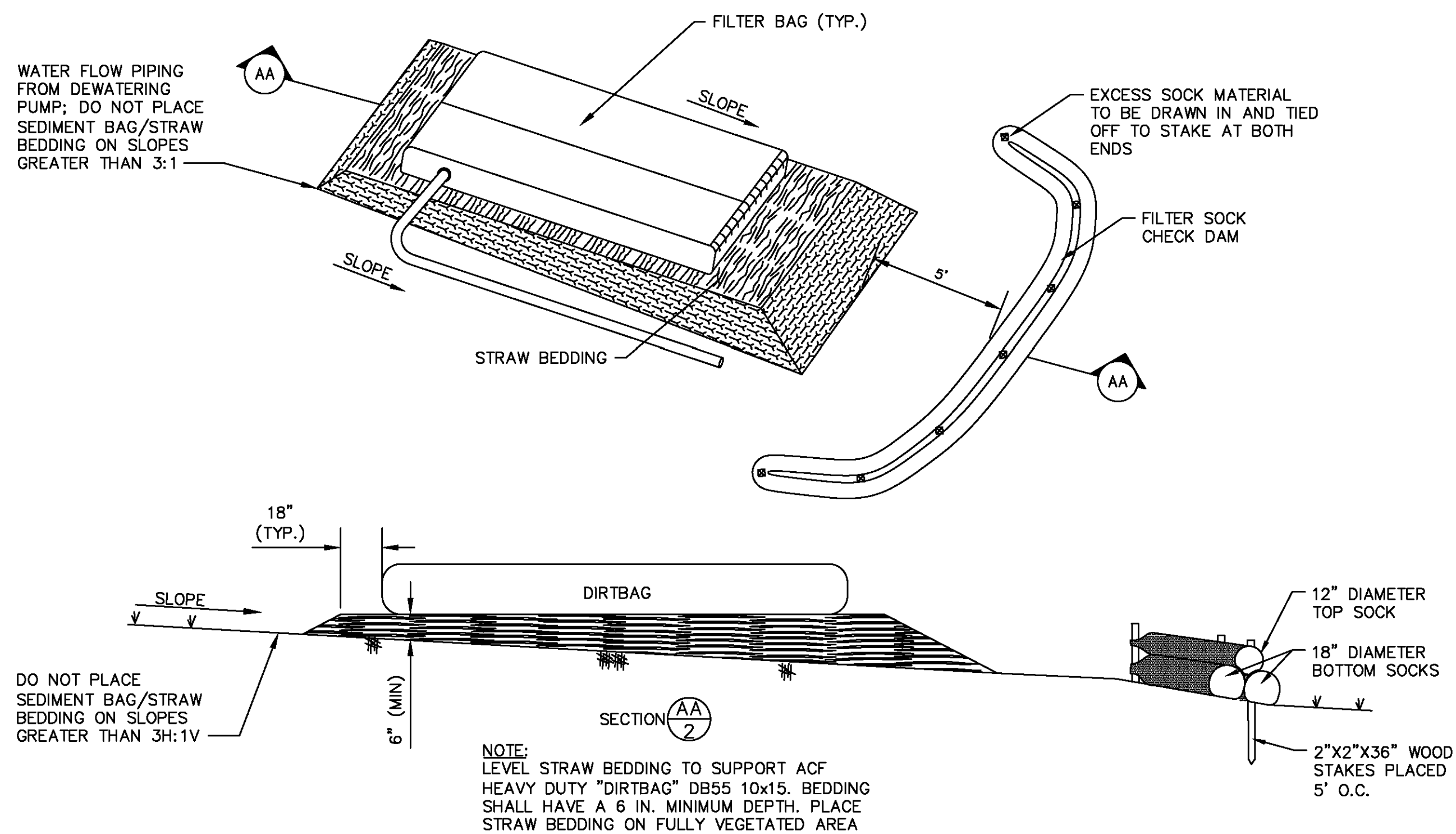

DEWATERING PROTECTION DETAIL **D**  
SCALE: N.T.S.  
**2**

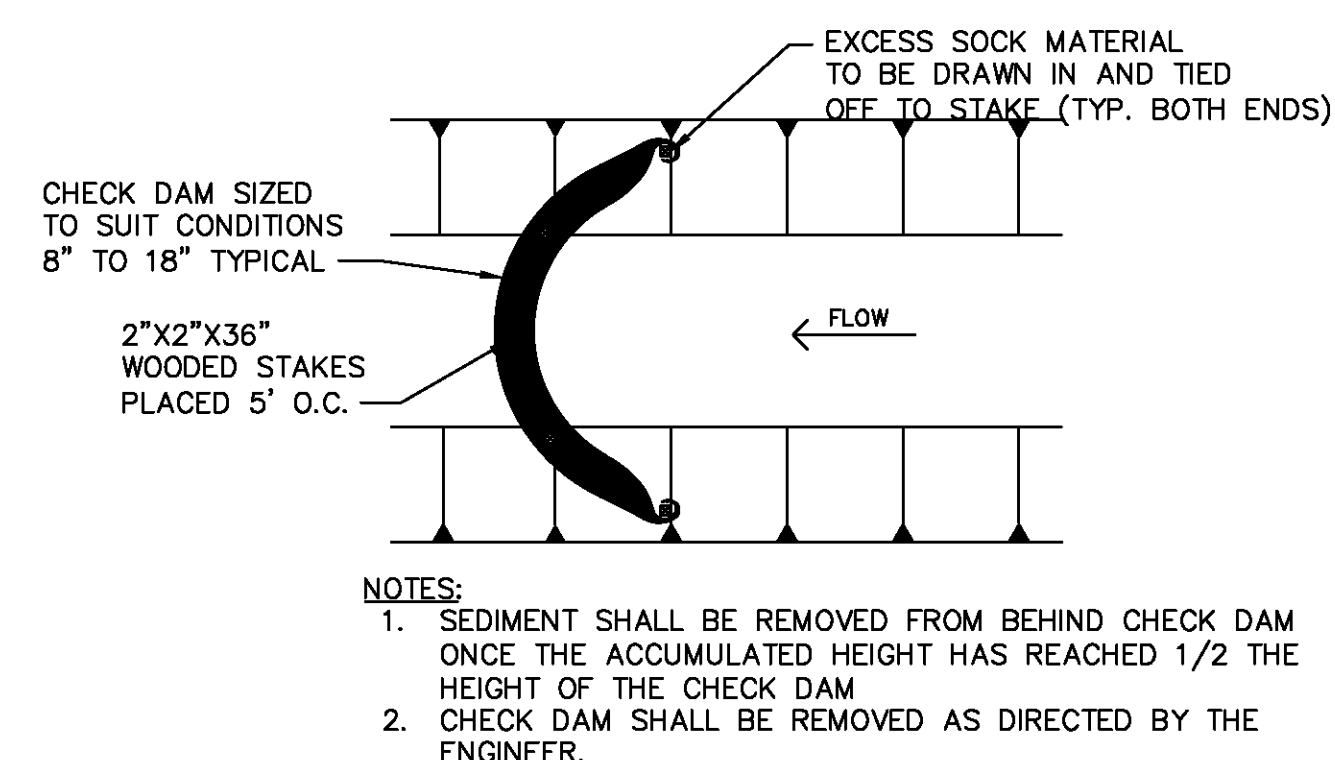

FILTER SOCK CHECK DAM DETAIL (TYP.) **F**  
SCALE: N.T.S.  
**2**

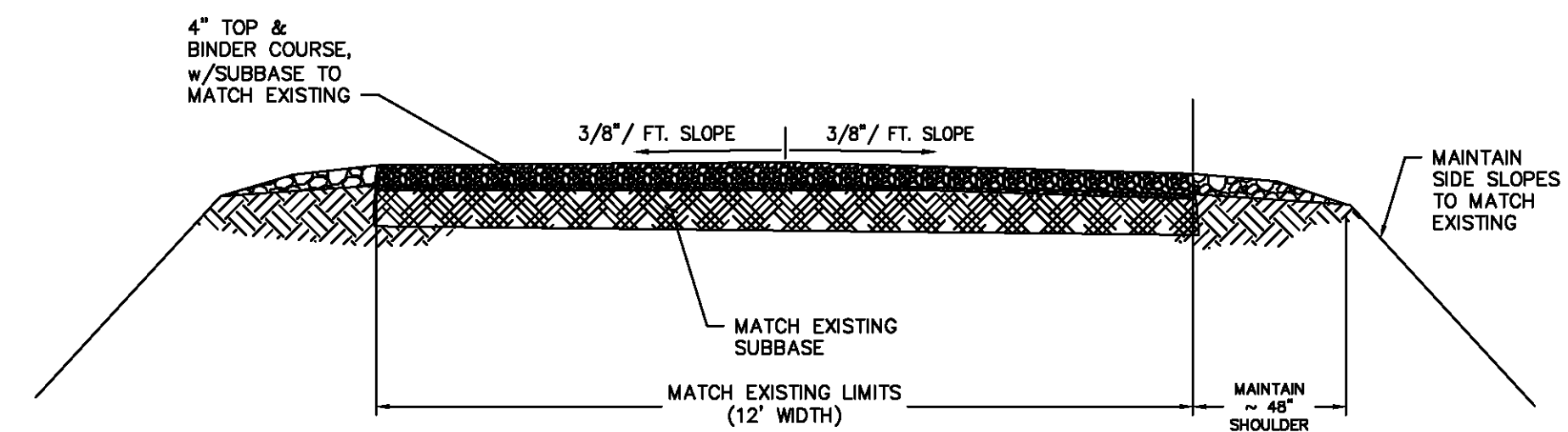

ROADBED SECTION DETAIL **C-2**  
SCALE: 1/4"=1'-0"  
**2**

RECOMMENDED FOR APPROVAL BY:

PROJECT ENGINEER	BUREAU OF DESIGN AND CONSTRUCTION
DATE	DATE
CHEF	BUREAU OF DESIGN AND CONSTRUCTION
DATE	DATE
DIRECTOR	DIVISION OF OPERATIONS
DATE	DATE

PROJECT DESCRIPTION  
UPPER CHATEAUGAY LAKE BLS  
CULVERT REPLACEMENT  
**PROJECT PLANS & DETAILS**

FACILITY NAME	UPPER CHATEAUGAY LK BLS
FACILITY NO.	1046
PROJECT NO.	5-2407
DATE	JAN. 2025
SCALE	1" = 30'
DRAWING NO.	<b>2</b>